

Plan of Horn Pond Estate WOBURN.

R.H. Eddy, Eng^r Boston

October 15th 1844. Scale 50 f = 1 inch

(Original on file)
(Scale of this plan: 1 in. = 100 ft.)

We the subscribers certify this plan is the one referred to in a deed signed by Abbott Lawrence Esqr. President of the Middlesex Canal Corporation, to William Sturgis Esqr. dated Oct 15th 1844; and likewise the same referred to in the lease signed by Abbott Lawrence, President of the Middlesex Canal Corporation, to William Sturgis, dated Oct 15th 1844.

Abbott Lawrence
President of the Middlesex
Canal Corporation
Wm. Sturgis

Witness
Caleb Eddy

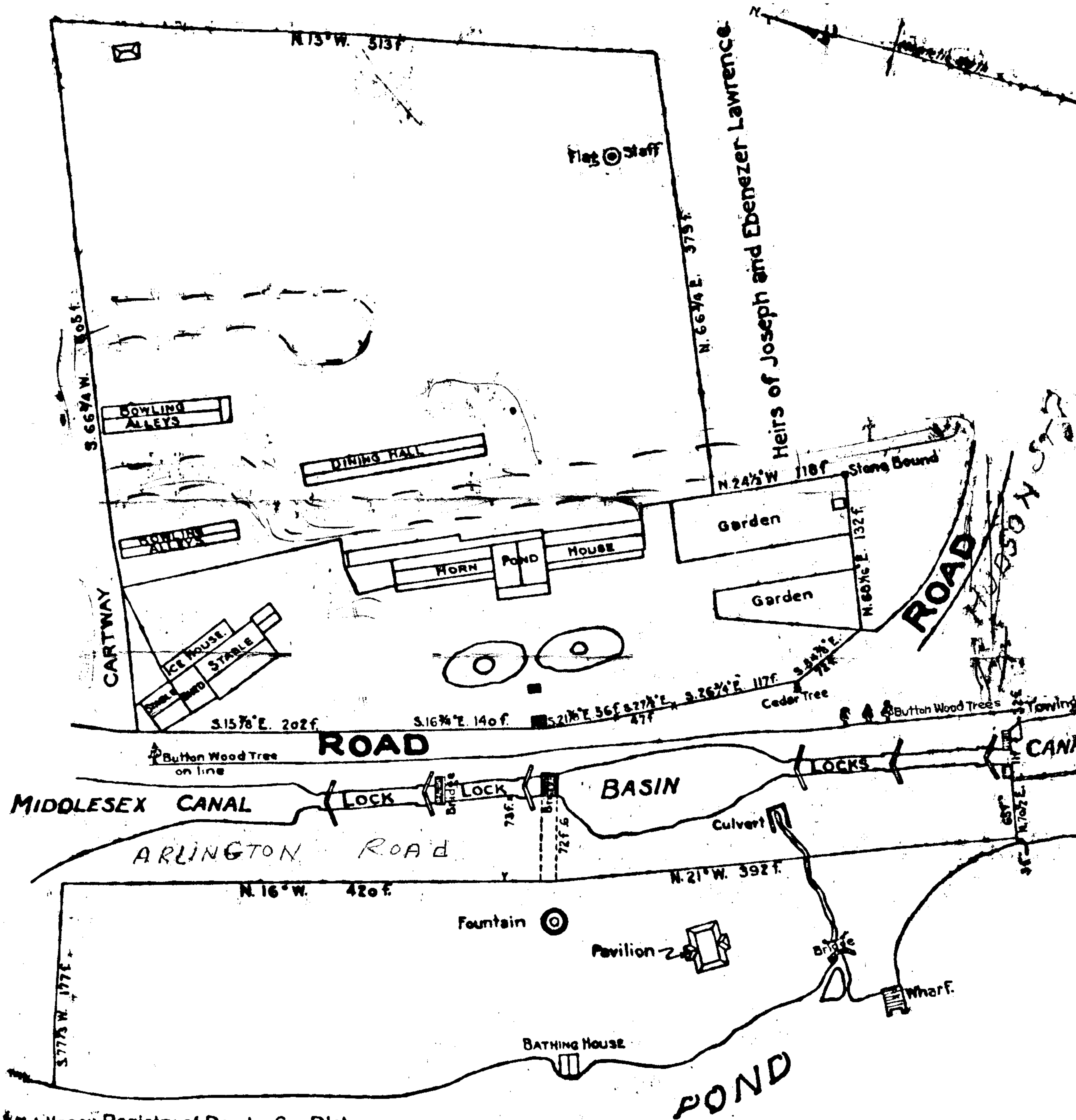

Middlesex Registry of Deeds, So. Dist.
CAMBRIDGE, MASS.

Received — 19 — at — H — M — M
with
A Copy of Plan

Recorded in Plan Book I-B. Plan 47.

HORN

This copy made Oct. 25, 1932
by Plan Department

Harold J. Grant